

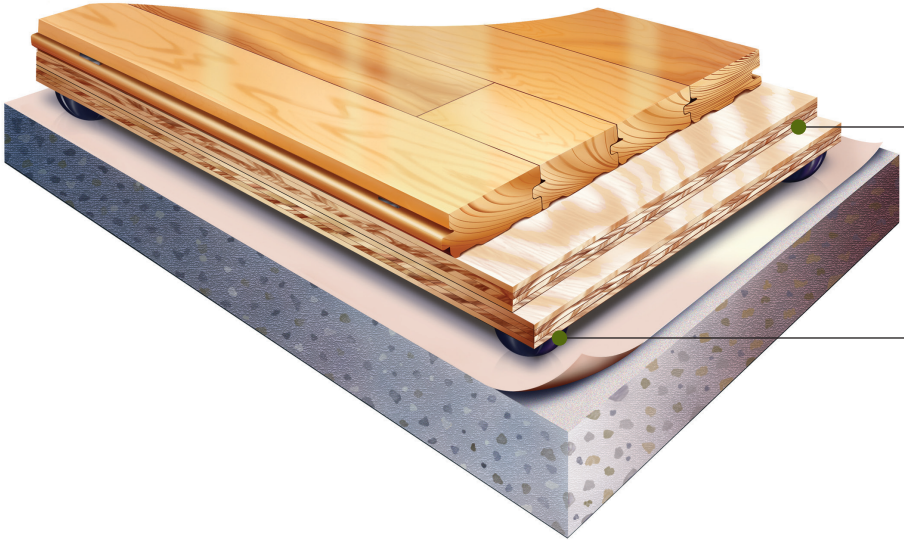

# ProAction Thrust™ Floor System

SYSTEM TYPE: FLOATING RESILIENT



*Two Layers  
15/32" (12 mm)  
Plywood Subfloor*

*ProAction 3/4" (19 mm)  
Natural Rubber Pads*

**MFMA NORTHERN HARD MAPLE  
BY ACTION:**

Random Length (RL)  
Action Long Length (FJ)

**TESTING AGENCY:**

Certified by ISSS

**PERFORMANCE MEETS OR EXCEEDS:**

EN 14904 Type 4  
DIN 18032 Part 2  
FIBA Level I

**SLAB DEPRESSION:**

25/32" (20 mm): 2-1/2" (64 mm)  
33/32" (26 mm): 2-3/4" (70 mm)

**LEED:**

FSC Maple & Subfloor available, MR credits — based on products, selected materials and facility locations

**PERFORMANCE & SYSTEM STABILITY:**

- Variable load response ProAction pads
- Excellent ball bounce
- SCORES Compliant
- Stable double layer plywood subfloor system
- Excellent shock absorption

- ProAction Thrust is well suited to applications where high performance is important and FIBA certification is desired.
- Features the proven, durable double plywood design.
- The manufacturer and flooring shall be independently verified by the guidelines of the ISO 14040-2006 and ISO 14044: 2006 Life Cycle Assessment (LSA) confirming a negative carbon footprint.
- Carbon Evaluation must be inclusive and based on all corporate facilities, offices and mills.
- The manufacturer and flooring shall be independently verified by the guidelines of the ISO 14064-1:2006 World Resource Institutes Greenhouse Gas Protocol, Scope 1, 2 and 3.
- The manufacturer and flooring shall be registered in the Collaborative for High Performance Schools (CHPS) Product Database.

Complete product specifications and system drawings (CAD and BIM) are available online at:

[www.actionfloors.com](http://www.actionfloors.com)

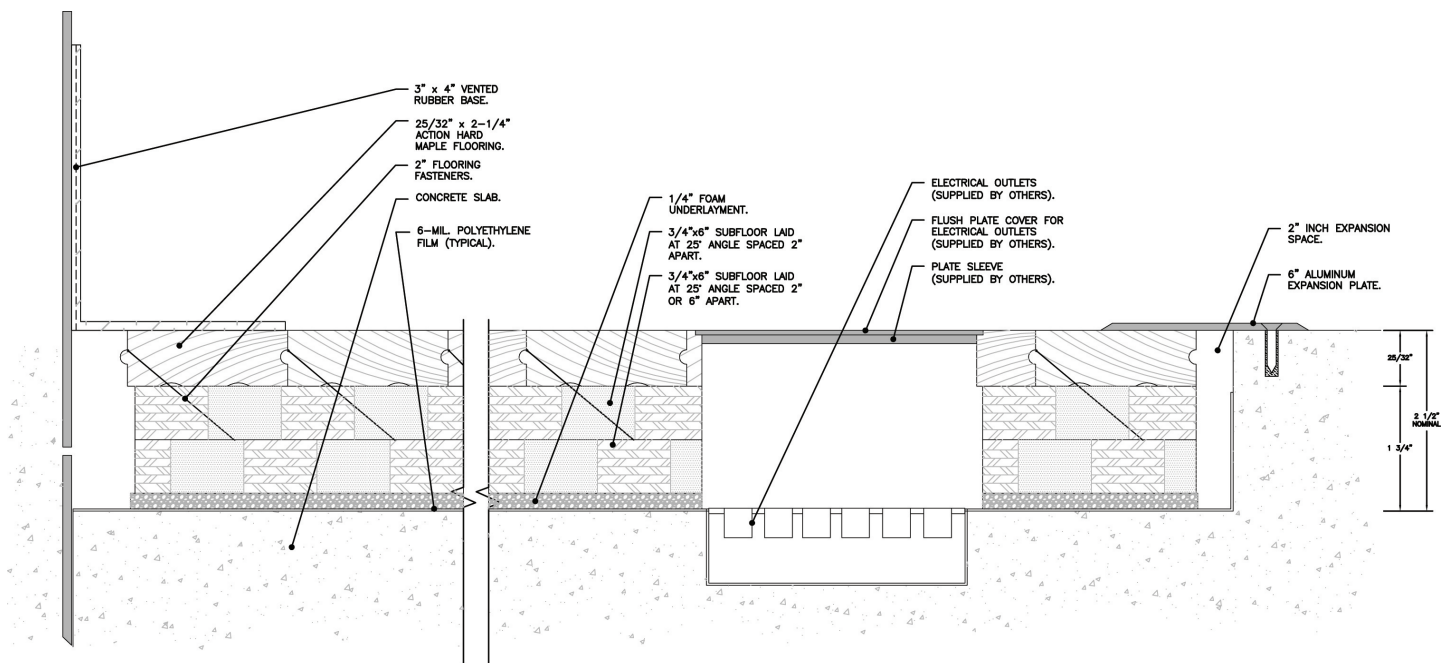

## Action ProAction Thrust



ACTION FLOOR SYSTEMS LLC  
4781 N. U.S. Hwy. 51 • Mercer, WI 54547-9708 U.S.A.

PHONE: 800.746.3512 or 715.476.3512 • FAX: 715.476.3585  
E-MAIL: [info@actionfloors.com](mailto:info@actionfloors.com)

[www.actionfloors.com](http://www.actionfloors.com)

