



# Action Cush II

SYSTEM TYPE: FLOATING RESILIENT



*Action Cush Sleepers*

*3/8" Action Cush Pad or optional 7/16" Airtech II natural rubber pad*

**MFMA NORTHERN HARD MAPLE  
BY ACTION:**

Random Length (RL)  
Action Long Length (FJ)

**TESTING AGENCY:**

Certified by ISSS

**PERFORMANCE MEETS OR EXCEEDS:**

**SLAB DEPRESSION:**

25/32" (20 mm): 2-5/8" (67 mm)  
33/32" (26 mm): 3-7/8" (73 mm)

**LEED:**

FSC Maple & Subfloor available, MR credits - based on products, selected materials and facility locations.

**PERFORMANCE & SYSTEM STABILITY**

- Combination of sleepers and maple create high profile cushioned system
- Provides for good air flow
- Excellent shock absorption

- The combination of the 3/8" Action Cush pad or 7/16" AirTech II natural rubber pads, ActionCush sleepers and maple created a high profile cushioned system.
- Action Cush II floor system floats on the slab to create excellent shock absorption along with great air flow.
- The manufacturer and flooring shall be independently verified by the guidelines of the ISO 14040-2006 and ISO 14044:2006 Life Cycle Assessment (LSA) confirming a negative carbon footprint.
- Carbon Evaluation must be inclusive and based on all corporate facilities, offices and mills
- The manufacturer and flooring shall be independently verified by the guidelines of the ISO 14040-2006 World Resource Institutes Greenhouse Gas Protocol, Scope 1, 2 and 3.
- The manufacturer and flooring shall be registered in the Collaborative for High Performance Schools (CHPS) Product Database.

Complete product specifications and system drawings (CAD and BIM) are available online at:

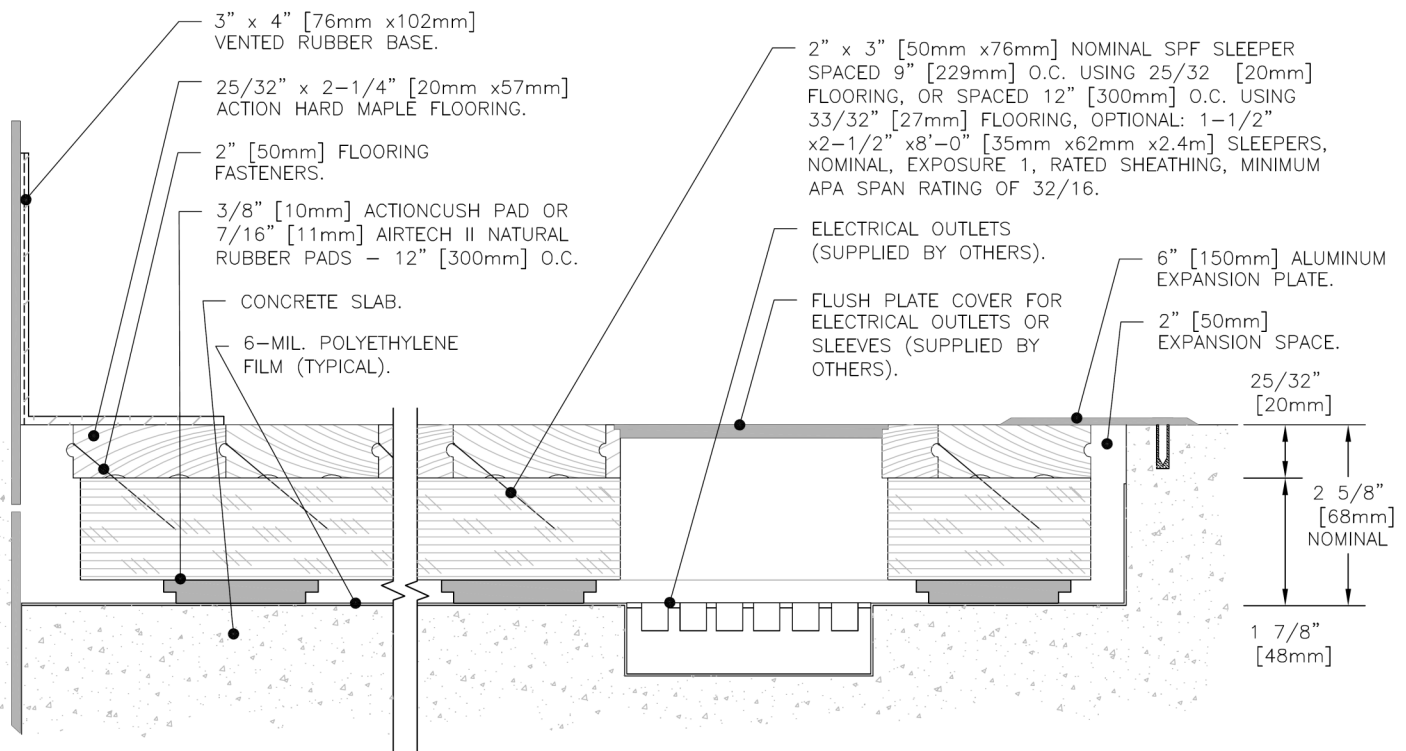

## Action Cush II



**ACTION FLOOR SYSTEMS LLC**

4781 N. U.S. Hwy. 51 Mercer, WI 54547-9708 U.S.A

**PHONE:** 800-746-3512 or 715-476-3512 **FAX:** 715-476-3585

**E-MAIL:** [info@actionfloors.com](mailto:info@actionfloors.com)

**[www.actionfloors.com](http://www.actionfloors.com)**